

Fitting the brackets

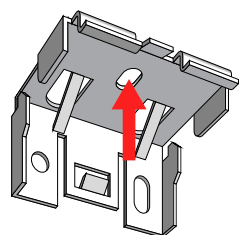

Top Fix:
Use the single oval hole in the centre of the top plate of the bracket when mounting upwards into the ceiling or top of a recessed area.

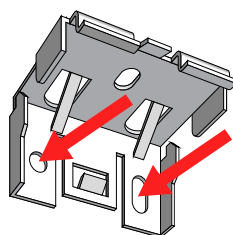

Face Fix:
Use the two holes on the rear plate of the bracket when mounting face onto a wall or window frame.

Fitting the blind

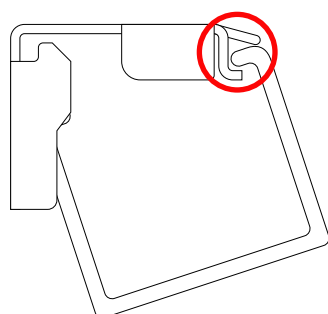

Step 1:
Locate the front lip of the rail onto the front lip of the brackets, hold the rail at a slight angle while doing so.

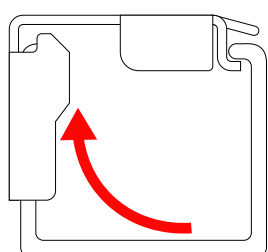

Step 2:
Push the back of the rail upwards, you should hear an audible 'click' as the rail locks into the bracket.

Additional Information

The first time you lower the blind you may find that the drop appears short. This is normal and the blind should be left down for 24 hours so the compressed pleats can expand and settle. Please do not attempt to make any adjustment to the blind or cords.

Use a damp sponge or cloth to clean the blind. Do not soak the blind as the pleats can loose their shape. Typically using a brush attachment and vaccuuming the blind is all that is required to maintain the appearance of the product.

If you need to remove the blind from the window, push the headrail back towards the window. This will disengage the rail from the rear hook and allow the blind to be easily removed.

Child Safety Device Installation

Cord safety cleat

Our blinds are provided as standard with a compliant child-safety device (cord safety-cleat), which must be installed. This is designed to ensure that the operating cords cannot form a loop equal to or greater than 220mm at less than 1600mm from floor level, safely preventing any risk of accidental strangulation.

The safety cleat shall be installed as close to the headrail as possible and **in all cases not less than 1600mm from the floor**, because a child is capable of unwinding a cord from a cleat.

The cord must be fully accumulated around the safety cleat(s) when the blind is not in use. Use the table below to determine the distance required between the cleats to fully accumulate the cords when the blind is fully raised.

| Drop of Blind | *Distance between cord cleats (centre to centre) |
|---------------|--|
| 1-1000mm | 100mm |
| 1001-2000mm | 150mm |
| 2001-3000mm | 300mm |

Place the safety cleat in the desired position on the wall and mark the positions of the holes with a pencil.

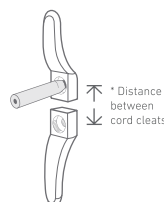

Mark the hole positions and drill as required. Use the screws provided to attach the safety cleat to the wall.

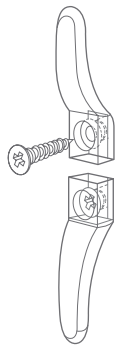

Wrap the cords around the cord cleats in a figure of 8. When the cords are fully accumulated ensure they are secure so when any cord is pulled no excess cord is released.



Cord Condenser

A breakaway cord condenser is pre-fitted to the lift cords so that when a horizontal force is applied to the cords entering the condenser, it safely breaks away eliminating any hazardous loops.

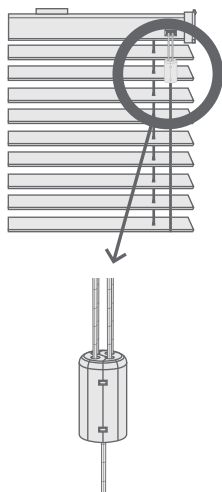

If the cord condenser is pulled apart:

Untangle and untwist cords.

For 2 cords: Press the cord condenser together until it is fully closed.

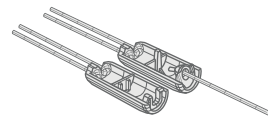

For 3 cords: Place the loose cord in the opening in one half of the cord condenser and press the cord condenser together until it is fully closed.

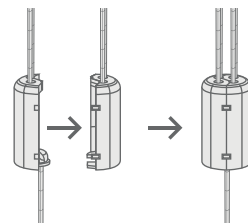

For 4 cords: Place one of the loose cords in the opening in one half of the cord condenser, the remaining loose cord in the opening in the other half and press the cord condenser together until it is fully closed.