

1

Positioning the brackets

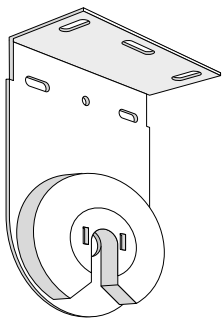

Pin-end bracket

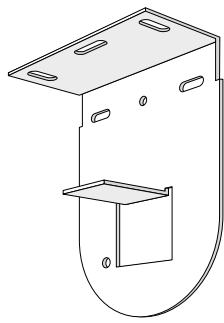

Control-end bracket

Face-Fix

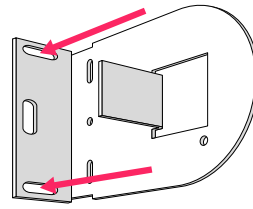

Top-Fix

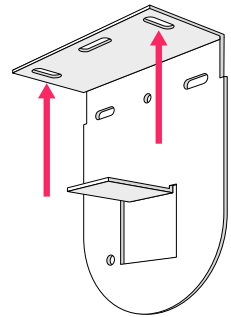

The brackets that are supplied with your blind enable you to face-fix the blind onto a wall/window frame, or top-fix the blind onto the ceiling/underside of a recess.

2

Fitting the blind

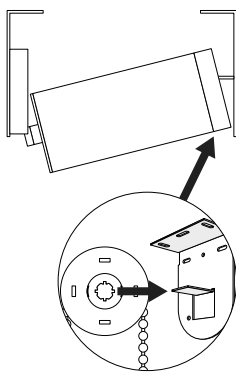

Slot the 'control' end of the blind into its bracket first

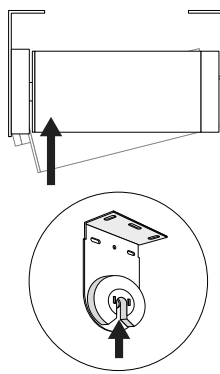

Slot the 'pin' up into the notch in its bracket, push up until level

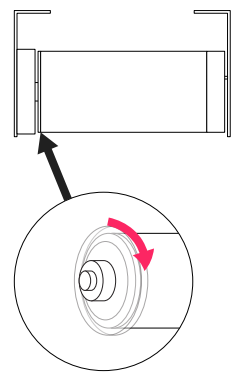

Spin the clear plastic cover to lock the pin in place in its bracket

3

Child Safety Device Installation

Our blinds are provided as standard with a compliant child-safety device (cord-guide), which must be installed.

This is designed to ensure that the operating cords cannot form a loop equal to or greater than 220mm, less than 1600mm from floor level, safely preventing any risk of accidental strangulation.

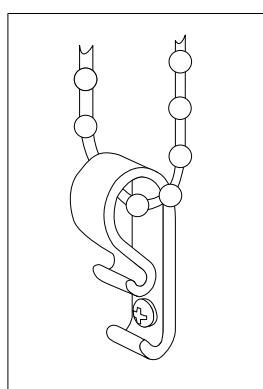
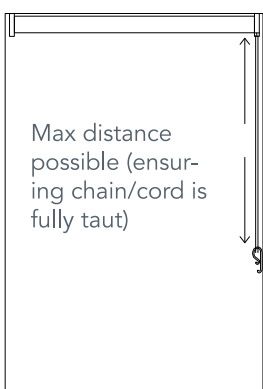

Hold the device against the wall and mark the location of the screw-holes with a pencil.

The cord must be taut, to ensure that should the device be less than 1600mm from floor level, a loop of 220mm length or greater cannot form.

Attach the cord-guide securely to the wall using the fixings provided.

It is designed in such a way that, so long as the cord is taut, the cord cannot be removed without removing the device.

4

Install the Chain Ball Stopper

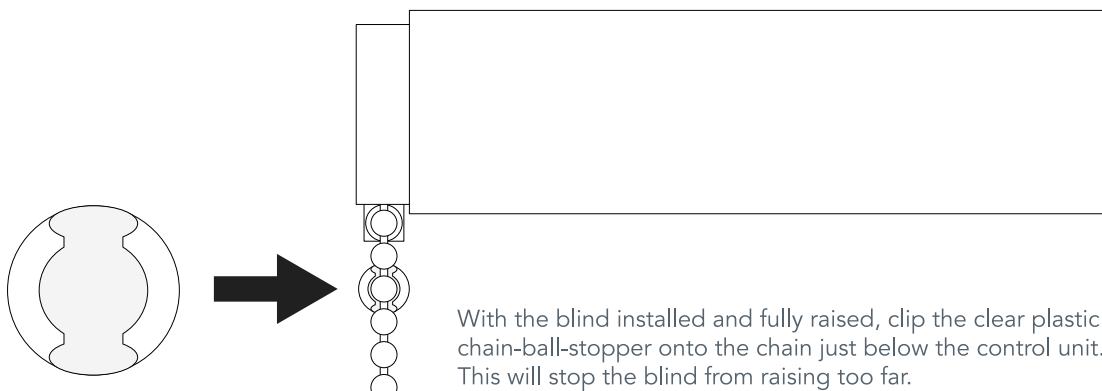

With the blind installed and fully raised, clip the clear plastic chain-ball-stopper onto the chain just below the control unit. This will stop the blind from raising too far.