

1

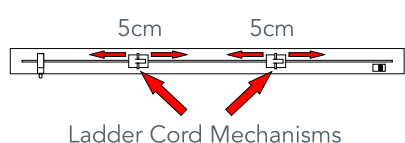

Place the blind into your window area and tilt the head rail towards you so that you can see the position of the ladder cord mechanisms within the rail. The position that you place the brackets must be at least 5cm away from the mechanisms. Use a pencil to mark the window area where the brackets will be positioned.

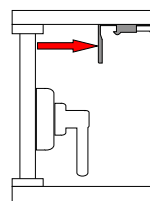

Ensure that the back of the bracket sits clear of any protruding items such as window handles or window vents. This will allow the blind to hang correctly once installed.

2

### Face Fix

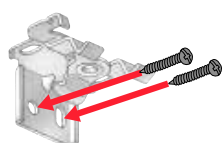

### Top Fix

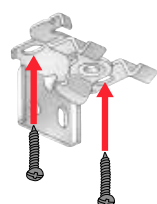

### Face-Fix:

Use this method to mount the blind to the surface directly behind the blind (commonly the wall or the window frame), use two screws for each of the brackets.

### Top-Fix:

Use this method to mount the blind to the surface directly above the blind (commonly the ceiling or the lintel of the recess), only one screw per bracket is required for top-fixing.

3

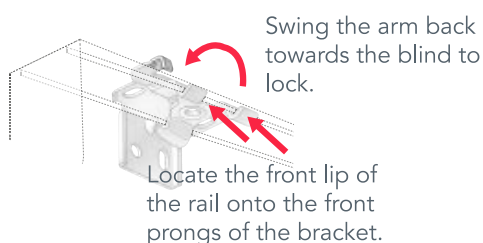

To attach the blind to the brackets, open the swing arm on the bracket so that it protrudes out. Locate the front lip of the rail onto the front prongs of the bracket. Then gently push the swing arm towards the back of the bracket to lock the rail into place.

To remove the rail, simply pull the swing arm at the front of the bracket outwards again.

4

## Child Safety Device Installation

### Cord safety cleat

Our blinds are provided as standard with a compliant child-safety device (cord safety-cleat), which must be installed. This is designed to ensure that the operating cords cannot form a loop equal to or greater than 220mm at less than 1600mm from floor level, safely preventing any risk of accidental strangulation.

The safety cleat shall be installed as close to the headrail as possible and **in all cases not less than 1600mm from the floor**, because a child is capable of unwinding a cord from a cleat.

The cord must be fully accumulated around the safety cleat(s) when the blind is not in use. Use the table below to determine the distance required between the cleats to fully accumulate the cords when the blind is fully raised.

Drop of Blind	*Distance between cord cleats (centre to centre)
1-1000mm	100mm
1001-2000mm	150mm
2001-3000mm	300mm

Place the safety cleat in the desired position on the wall and mark the positions of the holes with a pencil.

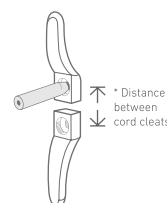

Mark the hole positions and drill as required. Use the screws provided to attach the safety cleat to the wall.

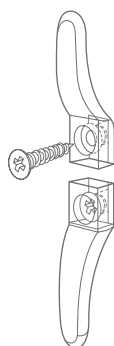

Wrap the cords around the cord cleats in a figure of 8. When the cords are fully accumulated ensure they are secure so when any cord is pulled no excess cord is released.



### Hold-Down Clips

As a requirement for child safety, our Venetians have to be fitted with hold down clips. Place the clips at the bottom of the window area so that they line up with the bottom of the blind when it is in the 'down' position. Screw the clip to the window sill or the wall (the side of the recess) with a single screw and a wall plug if installing into plaster.

'Click' the pegs on the bottom bar into the cups on the clips to secure the blind.

