

Position

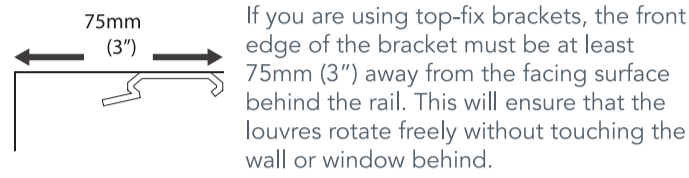

Install

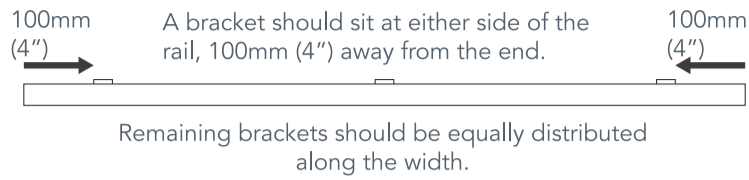
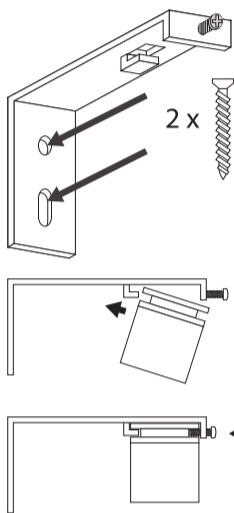

Face Fix Bracket

Use two screws to fix the bracket onto the facing surface.

Rest the rear ridge of the rail into the hook on the bracket. Lift the front of the rail up so that it sits flush with the bracket and tighten the front screw so that it secures into the front ridge of the rail.

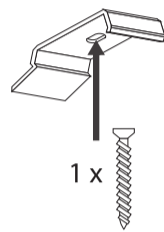

Top Fix Bracket

Use a single screw to fix the bracket into the surface above.

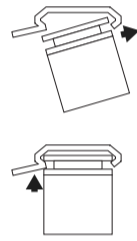

Rest the front ridge of the rail onto the front lip of the bracket. Lift the back of the rail to meet the bracket and press firmly upwards so that it clicks into place securely.

Child Safety Device Installation

Our blinds are provided as standard with a compliant child-safety device (cord-guide), which must be installed. This is designed to ensure that the operating cords cannot form a loop equal to or greater than 220mm, less than 1600mm from floor level, safely preventing any risk of accidental strangulation.

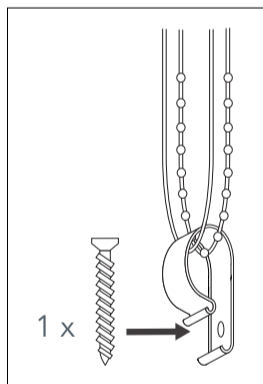
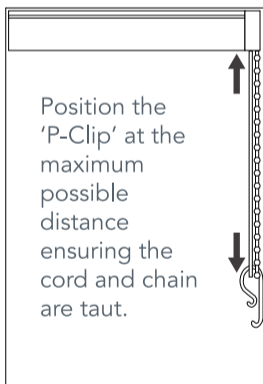

Hold the device against the wall and mark the location of the screw-holes with a pencil.

The cord must be taut, to ensure that should the device be less than 1600mm from floor level, a loop of 220mm length or greater cannot form.

Attach the cord-guide securely to the wall using the fixings provided.

It is designed in such a way that, so long as the cord is taut, the cord cannot be removed without removing the device.

Please note that the 'P-Clip' must be installed. The cord must be kept under tension to prevent it sagging out of the rail when the blind is drawn open.

Assemble

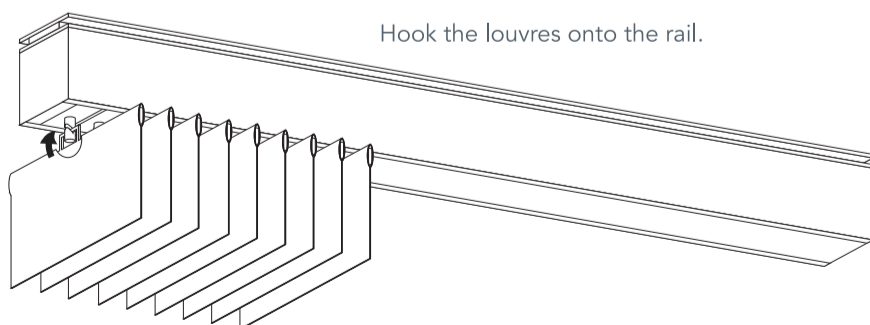

Top Tip

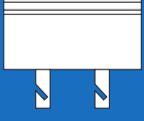

Before hooking the louvres on the rail, use the beaded chain to turn the hooks so that they all face side on. This makes it far quicker to hook the louvres on and also ensures that the louvres will not clash when you first use the blind.

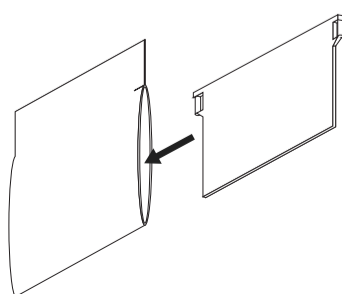

Slide the weight into the pocket at the bottom of the louvre.

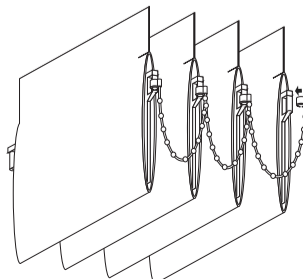

Clip the stabilising chain onto the weights, one chain will run along the back and the second will run along the front. Any excess clips can be cut away. Just snip the cord flush to the last clip attached to a weight.