

**Fitting the brackets**

**1**

There are two types of brackets for vertical blinds, each of which offers a different method of installation:

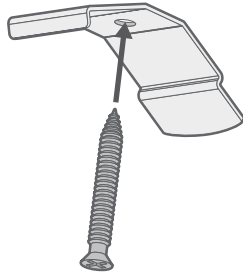

**Top-Fixing**

Use the single hole in the top of the bracket to fix to the lintel (the 'ceiling' of the recess). The protruding tab on the bracket should be closest to the window

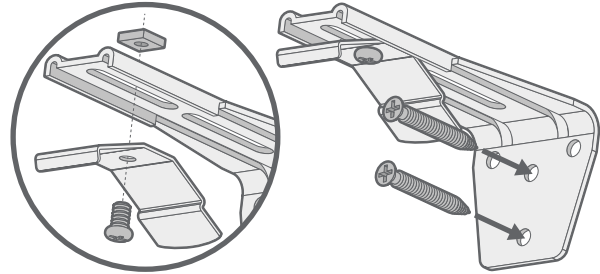

**Face-Fixing**

Join the bracket to the 'L' shaped face-fixing plate. Use two screws through the back plate to mount onto a facing surface (a wall or window frame)

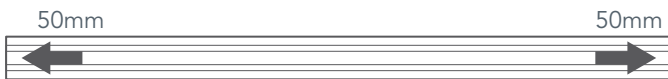

Note that the position of the outermost brackets should be at least 50mm away from the ends of the rail, with any other brackets evenly distributed across the width.

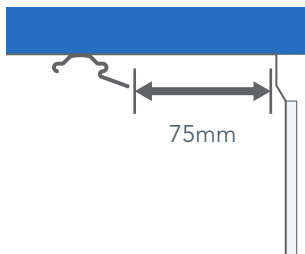

If you're using top-fix brackets, make sure that you mount them at least 75mm in front of either the window frame, or any protruding vents or handles, if there are any. This allows space for the louvres to turn open and closed.

**Fitting the blind**

**2**

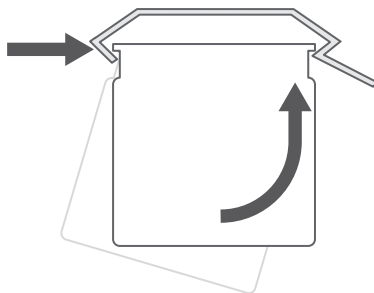

Situate the front lip of the headrail into the front of the bracket.

Lift the back of the headrail and push up firmly to secure the back of the rail into the bracket.

**Hanging the louvres**

**3**

**Top Tip**

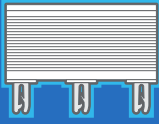

Before hooking the louvres onto the rail, make sure the hooks are turned so they all face sideways. This makes it quicker to attach the louvres and ensures they won't clash when you first use the blind.

Hook the louvres onto the rail by pushing the carriers at the top of the louvres, up into the pegs attached to the headrail.

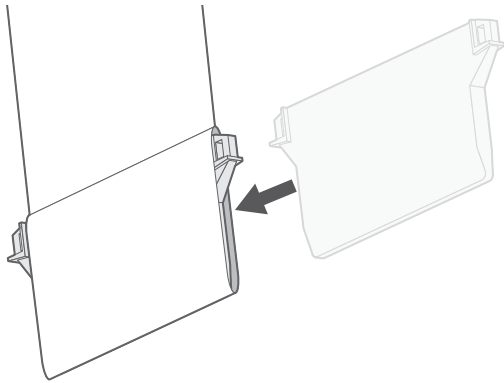
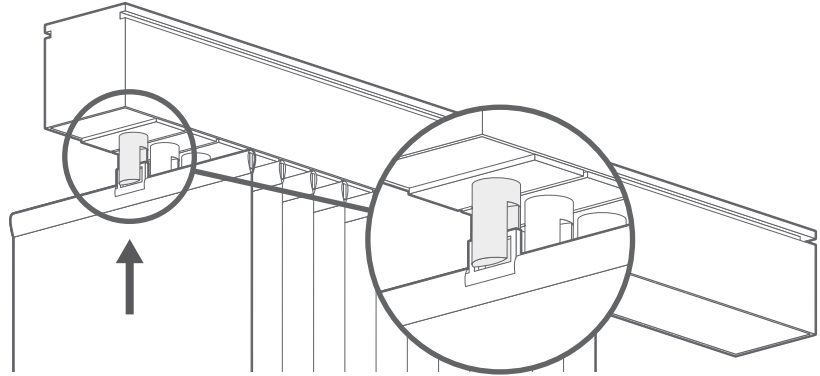

Slide the weight into the pocket at the bottom of the louver.